

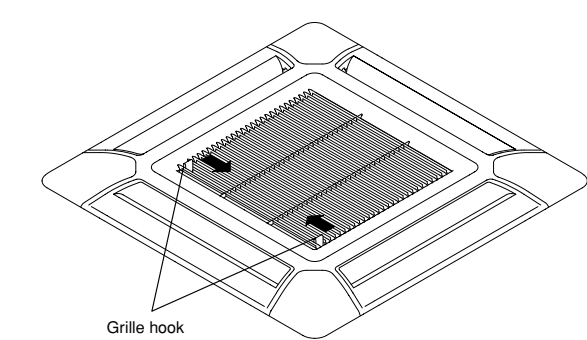

## 5 DECORATION PANEL INSTALLATION

### 1. REMOVE THE INTAKE GRILLE

- (1) Slide the 2 grille hook



- (2) Open the intake grille and remove.

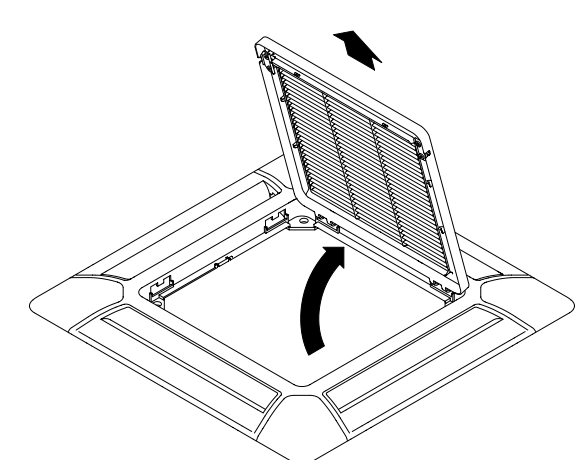

### 2. INSTALL PANEL TO INDOOR UNIT

- (1) Install the decoration panel on the indoor unit.

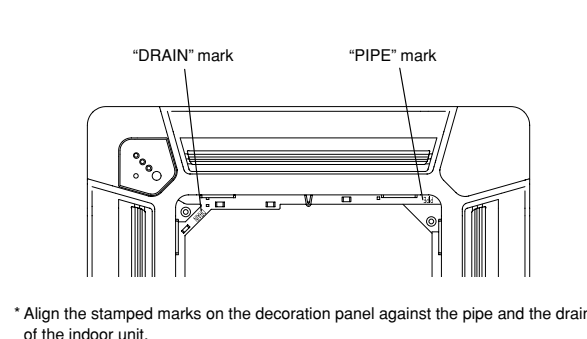

\* Align the stamped marks on the decoration panel against the pipe and the drain of the indoor unit.

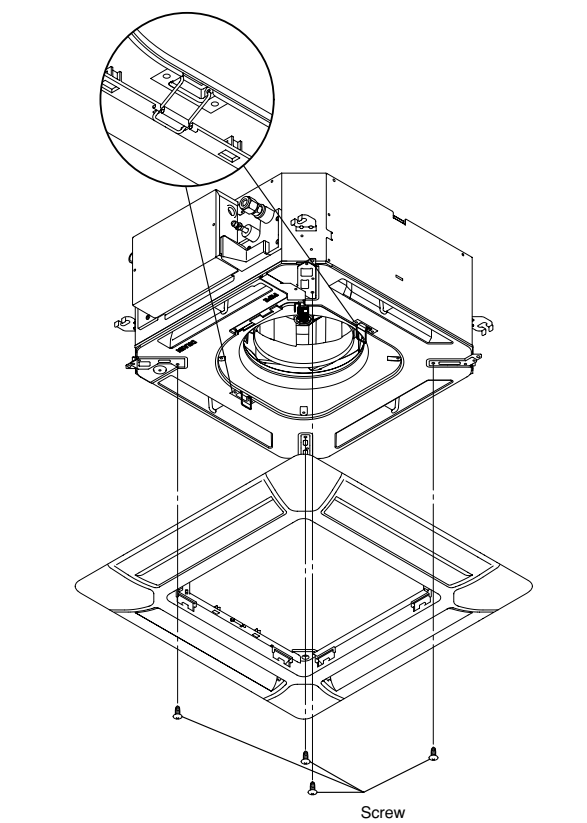

#### CAUTION

Use only the supplied screws to install the decoration panel.

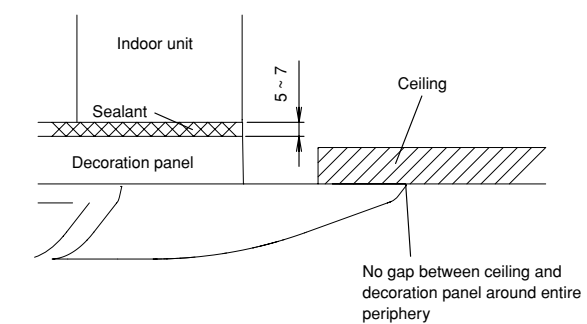

- (2) Connect the connector.

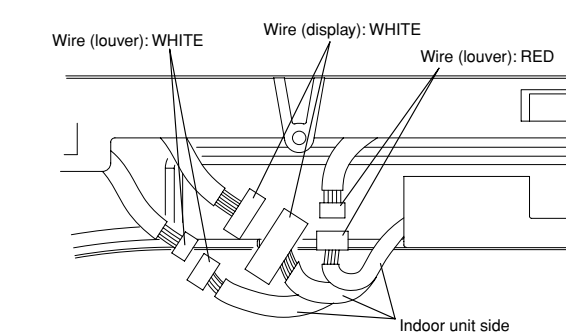

- Arrange the wires as illustrated below.

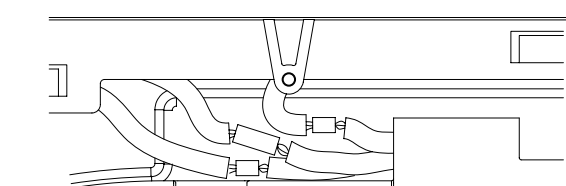

- (3) Attach the connector cover.

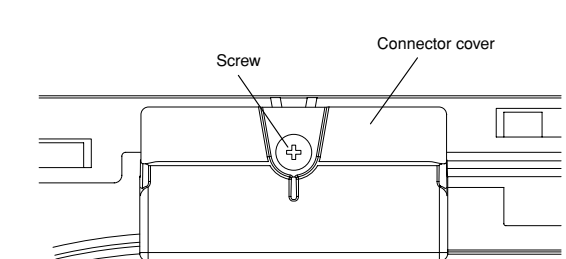

### 3. ATTACH THE INTAKE GRILLE

The installation is the reverse of "REMOVING THE INTAKE GRILLE". The intake grille can be rotated and installed 4 ways to suit the user's preference.

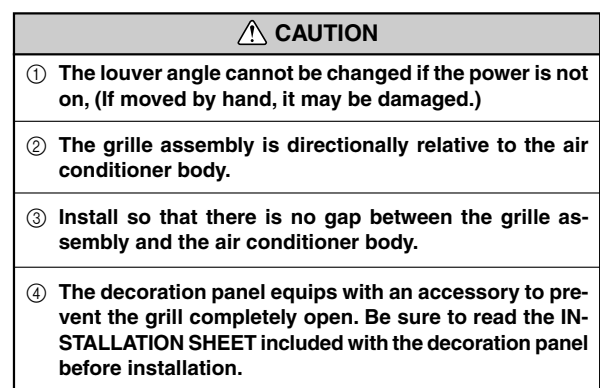

## 6 REMOTE CONTROLLER SETTING

### 1. Load Batteries (R03/LR03 x 2)

- (1) Press and slide the battery compartment lid on the reverse side to open it. Slide in the direction of the arrow while pressing the mark.
- (2) Insert batteries. Be sure to align the battery polarities (+/-) correctly.
- (3) Close the battery compartment lid.

#### CAUTION

- Take care to prevent infants from accidentally swallowing batteries.
- When not using the Remote Control Unit for an extended period, remove the batteries to avoid possible leakage and damage to the unit.
- If leaking battery fluid comes in contact with your skin, eyes, or mouth, immediately wash with copious amounts of water, and consult your physician.
- Dead batteries should be removed immediately and disposed of properly, either in a battery collection receptacle or to the appropriate authority.
- Do not attempt to recharge dry batteries.

#### NOTES

- Never mix new and used batteries, or batteries of different types.
- Batteries should last about one year under normal use. If the Remote Control Unit's operating range becomes appreciably reduced, replace the batteries and press the RESET button with the tip of a ballpoint pen or other small object.

### 2. REMOTE CONTROL UNIT HOLDER INSTALLATION

#### CAUTION

- Check that the indoor unit correctly receives the signal from the remote control unit, then install the remote control unit holder.
- Select the remote control unit holder selection site by paying careful attention to the following:  
Avoid places in direct sunlight.  
Select a place that will not be affected by the heat from a stove, etc.

- Install the remote control unit with a distance of 7 m between the remote control unit and the photocell as the criteria. However, when installing the remote control unit, check that it operates positively.
- Install the remote control unit holder to a wall, pillar, etc. with the tapping screw.

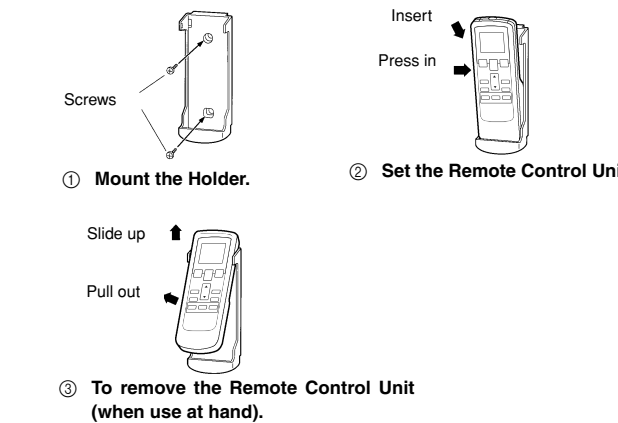

## 8 SWLECTING THE REMOTE CONTROL UNIT SIGNAL CODE

When two or more air conditioners are installed in a room and the remote control unit is operating an air conditioner other than the one you wish to set, change the signal code of the remote control unit to operate only the air conditioner you wish to set (four selections possible).

When two or more air conditioners are installed in a room, please contact your retailer to set the individual air conditioner signal codes.

- Confirm the setting of the remote control unit signal code and the printed circuit board setting.
- If these are not confirmed, the remote control unit cannot be used to operate for the air conditioner.

### Selecting the Remote Control Unit Signal Code

Use the following steps to select the signal code of the remote control unit. (Note that the air conditioner cannot receive a signal code if the air conditioner has not been set for the signal code.)

- (1) Press the START/STOP button until only the clock is displayed on the remote control unit display.
- (2) Press the MODE button for at least five seconds to display the current signal code (initially set to ).
- (3) Press the buttons to change the signal code between -. Match the code on the display to the air conditioner signal code.
- (4) Press the MODE button again to return to the clock display. The signal code will be changed.

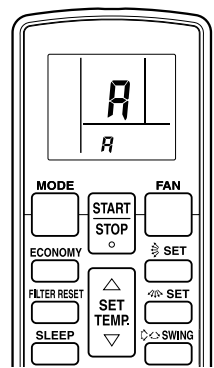

If no buttons are pressed within 30 seconds after the signal code is displayed, the system returns to the original clock display. In this case, start again from step 1.

The air conditioner signal code is set to A prior to shipment. Contact your retailer to change the signal code.

The remote control unit resets to signal code A when the batteries in the remote control unit are replaced. If you use a signal code other than signal code A, reset the signal code after replacing the batteries.

If you do not know the air conditioner signal code setting, try each of the signal codes (---) until you find the code which operates the air conditioner.

#### Indoor unit setting

Jumper wire	Remote control unit signal code
JM1	JM2
Connect	Connect
Disconnect	Connect
Connect	Disconnect
Disconnect	Disconnect

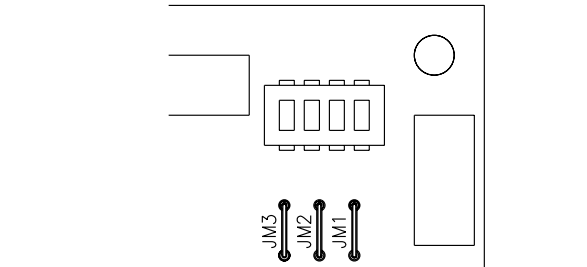
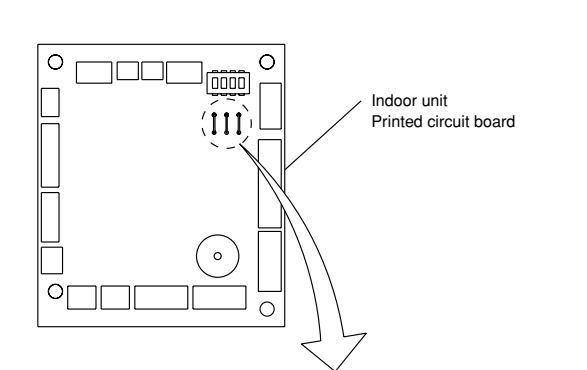

## 9 TEST RUN

### CHECK ITEMS

- (1) Is operation of each button on the remote control unit normal?
- (2) Does each lamp light normally?
- (3) Do not air flow direction louvers operate normally?
- (4) Is the drain normal?
- (5) Is there any abnormal noise and vibration during operation?

- Do not operate the air conditioner in the running state for a long time.

### CHECKING DRAINAGE

To check the drain, remove the water cover and fill with 1 l of water as shown in the figure. The drain pump operates when operating in the cooling mode.

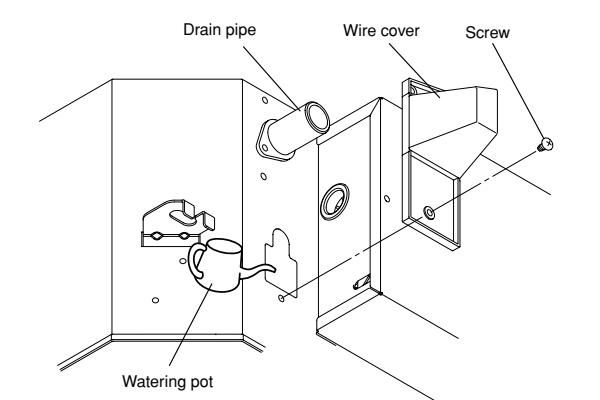

#### Test running

When the air conditioner is run by pressing the remote control unit test run button, the OPERATION and TIMER lamps flash slowly at the same time.

### [OPERATION METHOD]

- For the operation method, refer to the operating manual.
- The outdoor unit may not operate depending on the room temperature. In this case, press the test run button on the remote control unit while the air conditioner is running. (Point the transmitter section of the remote control unit toward the air conditioner and press the test run button with the tip of a ball-point pen, etc.)

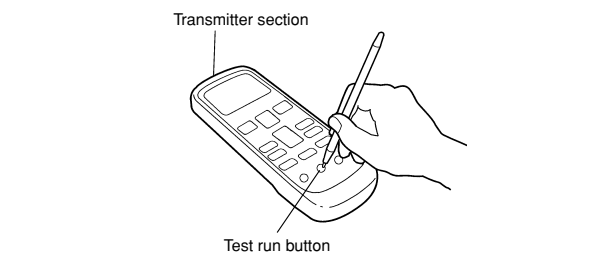

- To end test operation, press the remote control unit START/STOP button. (When the air conditioner is run by pressing the test run button, the OPERATION indicator lamp and TIMER indicator lamp and TIMER indicator lamp will simultaneously flash slowly.)

### [Using the wired remote control] (Option)

- For the operation method, refer to the operating manual.

- (1) Stop the air conditioner operation.
- (2) Press the master control button and the fan control button simultaneously for 2 seconds or more to start the test run.

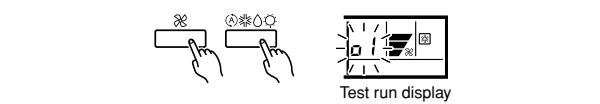

- (3) Press the start/stop button to stop the test run.

## TROUBLESHOOTING

### [Troubleshooting with the indoor display]

Troubleshooting at the display is possible either on the wired or wireless remote control.

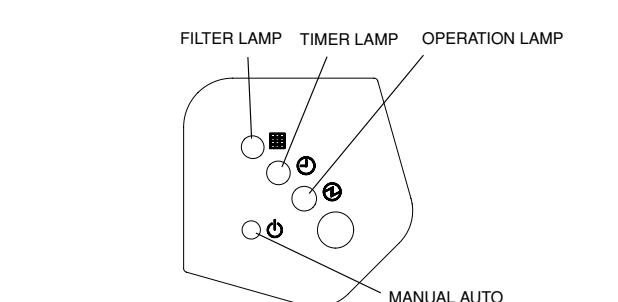

The OPERATION, TIMER and FILTER lamp operate as follows table according to the error contents.

Error contents	OPERATION lamp	TIMER lamp	FILTER lamp
Indoor signal error	X	○	X
Wired remote controller abnormal	X	(8 times) ○	X
Indoor room temperature sensor error	(2 times) ○	(2 times) ○	X
Indoor heat exchanger temperature sensor (middle) error	(2 times) ○	(3 times) ○	X
Indoor heat exchanger temperature sensor (inlet) error	(2 times) ○	(4 times) ○	X
Frost switch operated	(2 times) ○	(5 times) ○	X
Outdoor discharge pipe temperature sensor error	(3 times) ○	(6 times) ○	X
Outdoor heat exchanger temperature sensor (outlet) error	(3 times) ○	(3 times) ○	X
Compressor temperature sensor error	(3 times) ○	(4 times) ○	X
2-way valve temperature sensor error	(3 times) ○	X	(2 times) ○
3-way valve temperature sensor error	(3 times) ○	X	(3 times) ○
Outdoor heat exchanger temperature sensor (middle) error	(3 times) ○	X	(4 times) ○
Indoor manual auto switch abnormal	(4 times) ○	(2 times) ○	X
Power supply frequency detection error	(4 times) ○	(4 times) ○	X
IPM protection	(5 times) ○	(2 times) ○	X
CT error	(5 times) ○	(3 times) ○	X
Compressor location error	(5 times) ○	(5 times) ○	X
Outdoor fan error	(5 times) ○	(6 times) ○	X
Connected indoor unit abnormal	(5 times) ○	(7 times) ○	X
Outdoor unit computer communication error	(5 times) ○	(8 times) ○	X
Indoor fan abnormal	(6 times) ○	(2x3 times) ○	X
Discharge temperature error	(7 times) ○	(3 times) ○	X
Excessive high pressure protection on cooling	(7 times) ○	(4 times) ○	X
4-way valve abnormal	(7 times) ○	(5 times) ○	X
Pressure switch abnormal	(7 times) ○	(6 times) ○	X
Compressor temperature error	(7 times) ○	(6 times) ○	X
Active filter abnormal	(8 times) ○	(2x3 times) ○	X
PFC circuit error	(8 times) ○	(4 times) ○	X

○: 0.5s ON/0.5s OFF (Flash) X: OFF

## 7 FUNCTION SETTING

- This procedure changes to the function settings used to control the indoor unit according to the installation conditions. Incorrect settings can cause the indoor unit malfunction.
- After the power is turned on, perform the "FUNCTION SETTING" according to the installation conditions using the remote controller.
- The settings may be selected between the following two: Function Number or Setting Value.
- Settings will not be changed if invalid numbers or setting values are selected.

### Entering the Function Setting Mode

- While pressing the FAN button and SET TEMP. simultaneously, press the RESET button to enter the function setting mode.

### STEP 1

#### Selecting the Remote Control Unit Signal Code

Use the following steps to select the signal code of the remote control unit. (Note that the air conditioner cannot receive a signal code if the air conditioner has not been set for the signal code.)

The signal codes that are set through this process are applicable only to the signals in the FUNCTION SETTING. For details on how to set the signal codes through the normal process, refer to 8 SELECTING THE REMOTE CONTROL SIGNAL CODE.

- (1) Press SET TEMP. button to change the signal code between -. Match the code on the display to the air conditioner signal code. (Initially set to .) (If the signal code does not need to be selected, press the MODE button and proceed to STEP 2.)
- (2) Press the TIMER MODE button and check that the indoor unit can receive signals at the displayed signal code.

- (3) Press the MODE button to accept the signal code, and proceed to STEP 2.

The air conditioner signal code is set to A prior to shipment. Contact your retailer to change the signal code.

The remote control unit resets to signal code A when the batteries in the remote control unit are replaced. If you use a signal code other than signal code A, reset the signal code after replacing the batteries.

If you do not know the air conditioner signal code setting, try each of the signal codes (---) until you find the code which operates the air conditioner.

### STEP 2

SELECTING THE FUNCTION NUMBER AND SETTING VALUE  
Refer to the indoor unit installation instruction sheet for details on the function numbers and setting values.

#### Selecting the Function Number and Setting Value

- (1) Press the SET TEMP. buttons to select the function number. (Press the MODE button to switch between the left and right digits.)
- (2) Press the FAN button to proceed to setting the value. (Press the FAN button again to return to the function number selection.)
- (3) Press the SET TEMP. buttons to select the setting value. (Press the MODE button to switch between the left and right digits.)

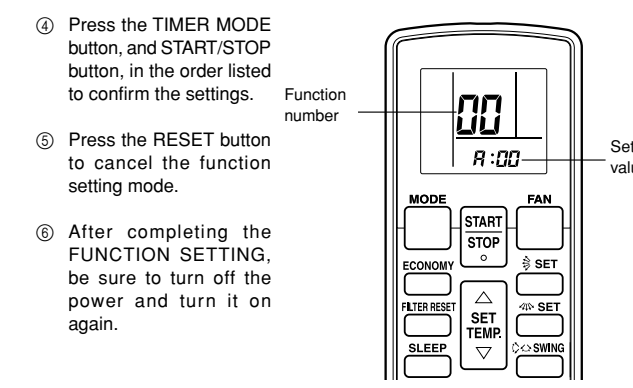

**CAUTION**  
After turning off the power, wait 10 seconds or more before turning it on again.  
The FUNCTION SETTING doesn't become effective if it doesn't do so.

### Setting the Ceiling Height

- Select the setting values in the table below according to the height of the ceiling. (The unit is factory-set to "00".)

Setting Description	Function Number	Setting Value
Standard (2.7 m)	20	00
High ceiling (3.0 m)		01

The ceiling height values are for the 4-way outlet. Do not change this setting in the 3-way outlet mode.

### Setting the Outlet Directions

- Select the setting values in the table below for using a 3-way outlet. (The unit is factory-set to "00".)

Setting Description	Function Number	Setting Value
4-way	22	00
3-way		01

### Setting the Filter Sign

- The indoor unit has a sign to inform the user that it is time to clean the filter.
- Select the time setting for the filter sign display interval in the table below according to the amount of dust or debris in the room. (The unit is factory-set to "00".)
- If you do not wish the filter sign to be displayed, select the setting value for "No indication".

Setting Description	Function Number	Setting Value
Standard (2,500 hours)		00
Long interval (4,400 hours)	11	01
Short interval (1,250 hours)		02
No indication		03

### Setting the Cooler Room Temperature Correction

- Depending on the installed environment, the room temperature sensor may require a correction. The settings may be selected as shown in the table below. (The unit is factory-set to "00".)

Setting Description	Function Number	Setting Value
Standard	30	00
Lower control		01

### Setting the Heater Room Temperature Correction

- Depending on the installed environment, the room temperature sensor may require a correction. The settings may be selected as shown in the table below. (The unit is factory-set to "00".)

Setting Description	Function Number	Setting Value
Standard		00
Lower control	31	01
Slightly warmer control		02
Warmer control		03

### Setting Other Functions

- The following settings are also possible, depending on the operating conditions. (The unit is factory-set to "00".)

Setting Description	Function Number	Setting Value
Yes	40	00
No		01

Indoor Room Temperature Sensor Switching Function (Wired remote controller only)

Setting Description	Function Number	Setting Value
No	42	00
Yes		01

- If setting value is "00", room temperature is controlled by the indoor unit temperature sensor.
- If setting value is "01", room temperature is controlled by either indoor unit temperature sensor or remote control unit sensor.

### Setting record

- Record any changes to the settings in the following table.

Setting	Setting Value
Ceiling height	
Outlet direction	
Filter sign	
Cooler room temperature correction	
Heater room temperature correction	
Auto restart	
Indoor room temperature sensor switching function	

After completing the FUNCTION SETTING, be sure to turn off the power and turn it on again.

## 10 SPECIAL INSTALLATION METHODS

### CAUTION

- ① When setting DIP switches, do not touch any other parts on the circuit board directly with your bare hands.
- ② Be sure to turn off the main power.

### 1. GROUP CONTROL SYSTEM

A number of indoor units can be operated at the same time using a single remote controller.

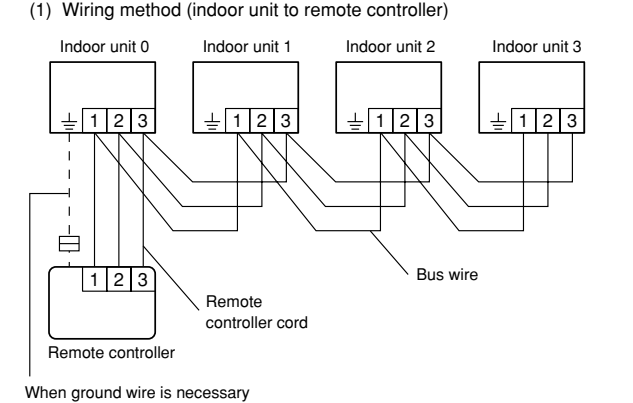

When ground wire is necessary

- (2) DIP switch setting (indoor unit)  
Set the unit number of each indoor unit using DIP switch on the indoor unit circuit board. (see following table and figure.)  
DIP switch is normally set to make unit number No. 0.

Unit number	1	2	3	4
0	OFF	OFF	OFF	OFF
1	ON	OFF	OFF	OFF
2	OFF	ON	OFF	OFF
3	ON	ON	OFF	OFF
4	OFF	OFF	ON	OFF
5	ON	OFF	ON	OFF
6	OFF	ON	ON	OFF
7	ON	ON	ON	OFF
8	OFF	OFF	OFF	ON
9	ON	OFF	OFF	ON
10	OFF	ON	OFF	ON
11	ON	ON	OFF	ON
12	OFF	OFF	ON	ON
13	ON	OFF	ON	ON
14	OFF	ON	ON	ON
15	ON	ON	ON	ON

Example : No. 3

